



AltRider DualControl Brake System for BMW R1200GSW

INSTALLATION INSTRUCTIONS

The most up to date instructions can be downloaded from the product page at altrider.com, under the instructions tab.

Dear Rider,
Thank you for choosing AltRider! Whether a seasoned world adventurer or a first time ADV-Newbie, we welcome you to the AltRider experience. You can install your new product with the utmost confidence. AltRider designs, tests, and manufactures all of its products here in the United States. We are proud to do what we do, and honored to present to you the product of our labors.

Enjoy it, show it off, and most of all, RIDE IT!

Venture On,
Jeremy LeBreton



AltRider DualControl Brake Kit for the BMW R 1200 GS Water Cooled

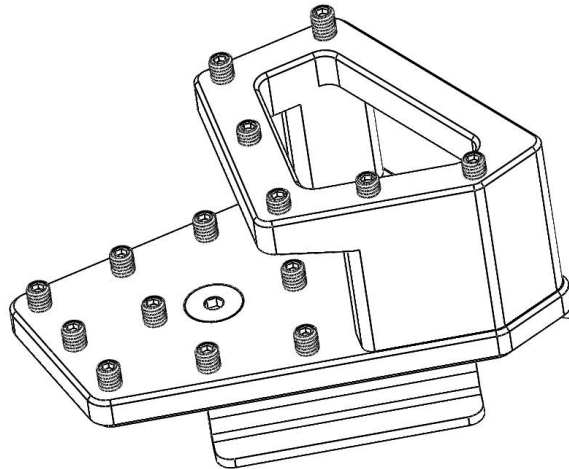

AltRider LLC

Global

mailing: 4000 Aurora Ave N Ste 100
Seattle, WA 98103 USA
206-922-3618
phone: info@altrider.com
email: www.altrider.com
web:

Europe

mailing: Heliumstraat 230
2718 RS Zoetermeer
Netherlands
info@altrider.eu
email: www.altrider.eu
web:



MADE IN THE USA



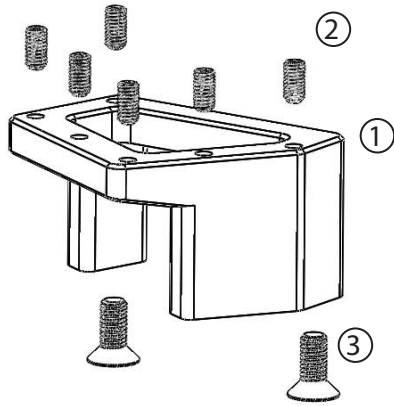

Riser Kit:

- ① Riser block
- ② (6) M4 x 8mm long grip pins
- ③ (2) M5 x 12 flat head screws

Installation Tools

- ① 2mm Allen key
- ② 3mm Allen key
- ③ 5mm Allen key
- ④ 8mm socket
- ⑤ Thread locker

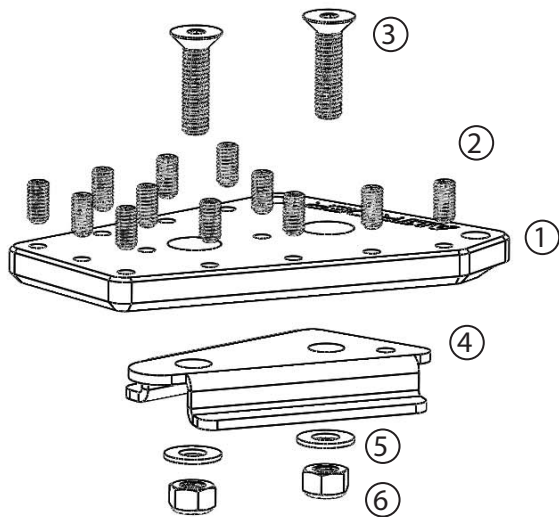

Enlarger Kit:

- ① Brake Pedal Enlarger
- ② (12) M4 x 8mm long grip pins
- ③ (2) M5 x 20 flat head screws
- ④ Steel bottom plate
- ⑤ (2) M5 washers
- ⑥ (2) M5 lock nuts



Brake Snake Kit:

- ① Brake snake cable
- ② M6 x 20 socket cap screw

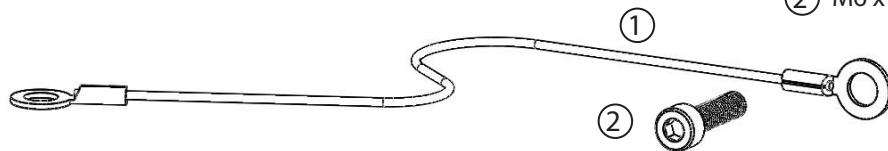

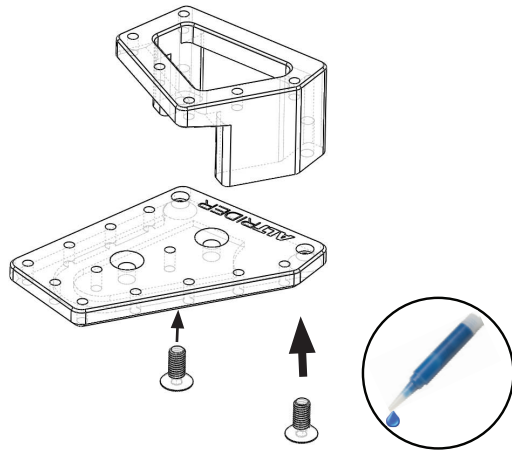

- ① If your kit is equipped with the full DualControl Enlarger + Riser, install the riser now. Place a drop of thread locker on each of the two (2) M5 x 12 flat head screws and use an M3 Allen to tighten the parts together.

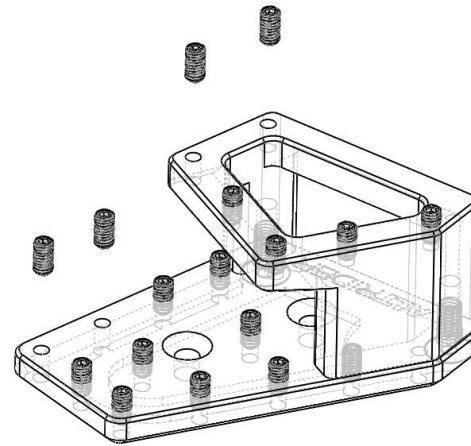

- ② Install M4 x 8mm Grip pins, using 2mm Allen driver. Use a small dot of thread locker on each pin. Total number and placement is up to you. Tighten snug, but be careful not to strip the tool.

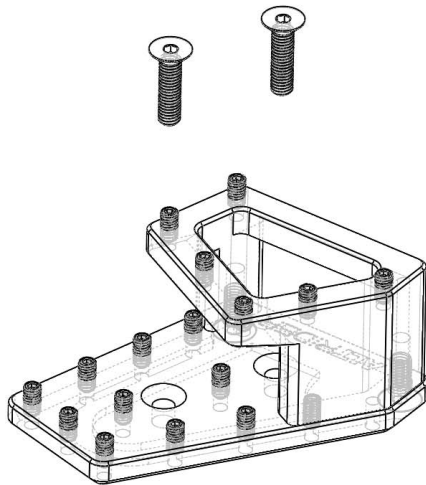

- ③ Place two (2) M5 x 20mm flat head screws through enlarger plate.

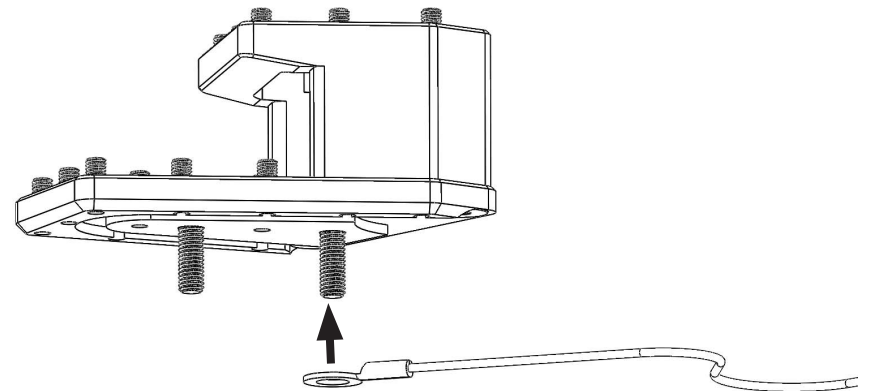

- ④ If you have the Brake Snake kit, place it around the M5 screw closest to the bike.

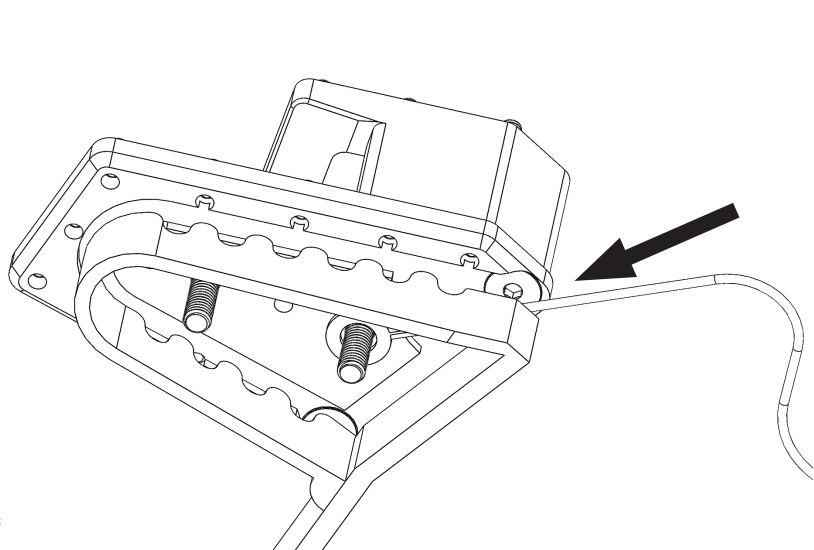

- ⑤ Place DualControl onto your bike's brake lever. Be sure the lever is seated in the groove on the underside of the Enlarger. Be sure the Brake Snake is on top of the lever in the position shown (arrow).

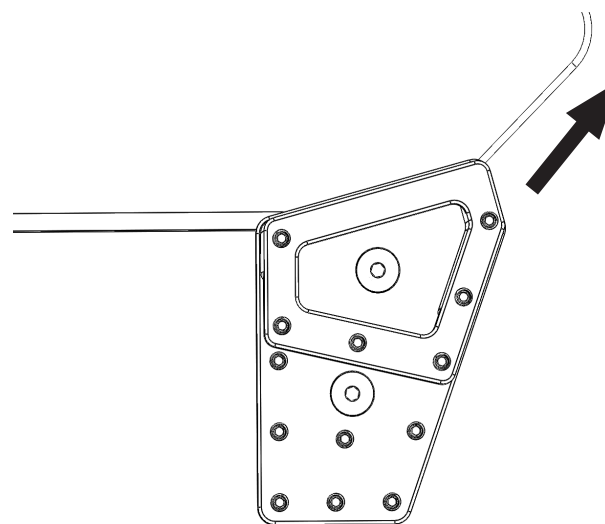

- ⑥ Correct Brake Snake cable location. Should be on top of lever, under enlarger.

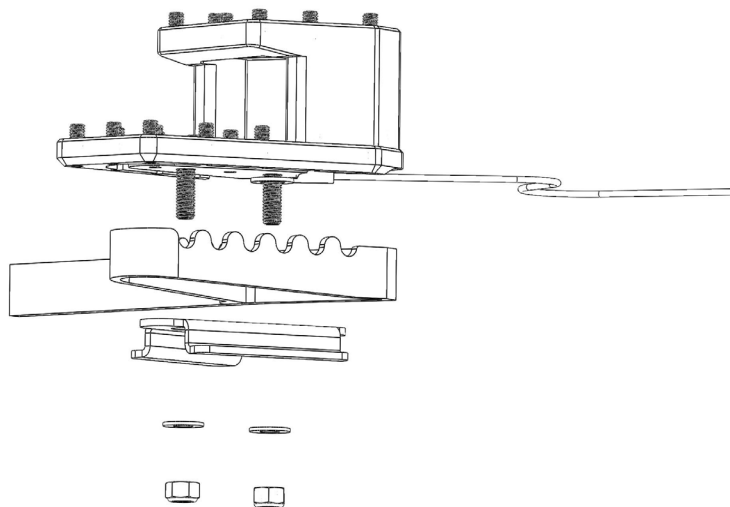

- ⑦ Attach DualControl to brake pedal with metal plate, washers, and lock nuts. Use M3 allen on screws and 8mm socket on locknuts and tighten snug.

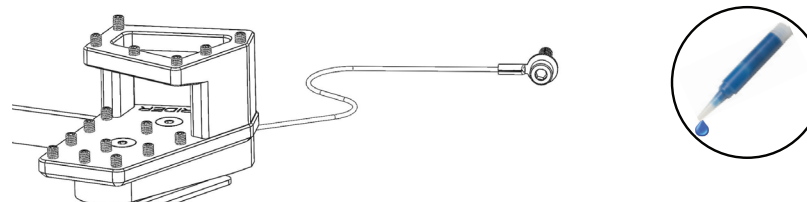
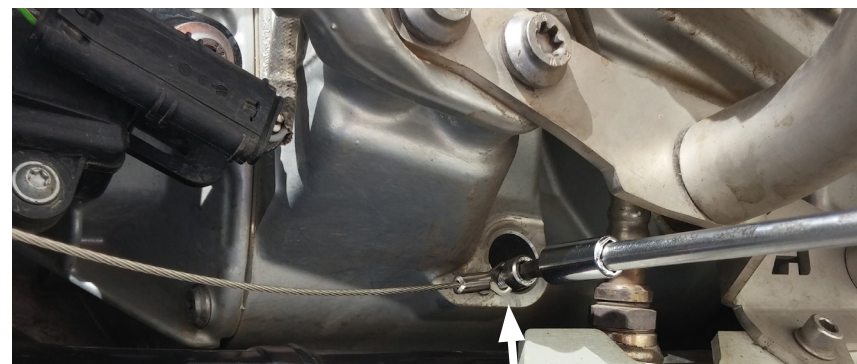

- ⑧ Install M6 screw with 5mm Allen driver. Use a drop of thread locker. Tighten into case location shown. The screw will stop turning when snug. The brake snake eyelet will remain loose around the bolt to allow movement.

Brake Lever Adjustment to lower height. (optional)

Begin with your lever adjusted to the correct factory position. It is extremely important that you start with your lever correctly adjusted. Mis-adjustment can cause major damage to the brake pads and rotors, and could possibly cause the rear brakes to be permanently squeezed "on", even with no pressure on the lever itself.



- ① Locate the master cylinder and plunger connected to the brake pedal, directly behind the right side foot peg. Note parts: (A) plunger shaft wrench flats. (B) Jam nut. (C) Yoke. (D) Pivot pin with cotter pin.
- ② Use a 10mm and 12mm open end wrench. With the 10mm wrench on top, hold the plunger still. There are wrench flats on the plunger right near the rubber boot where it enters the master cylinder. The plunger must not spin, this preserves the correct internal adjustment. While holding the plunger, use the 12mm wrench to loosen the jam nut.



- ③ Spin the jam nut higher up the plunger rod, toward the master cylinder. Do not spin the plunger rod itself.



- ④ Pull the small cotter pin. Pull the washer and the pivot pin that connects the yoke to the plunger.



- ⑤ Holding the plunger still, spin the yoke so it moves higher up the plunger, toward the master cylinder.



- ⑥ Reinsert the pin and check brake lever is at desired height. Reinstall washer and cotter pin.



- ⑦ Hold plunger still with 10mm wrench. Apply a drop of loctite to the threads below the jam nut. Spin jam nut down until it contacts the yoke. Tighten against yoke.

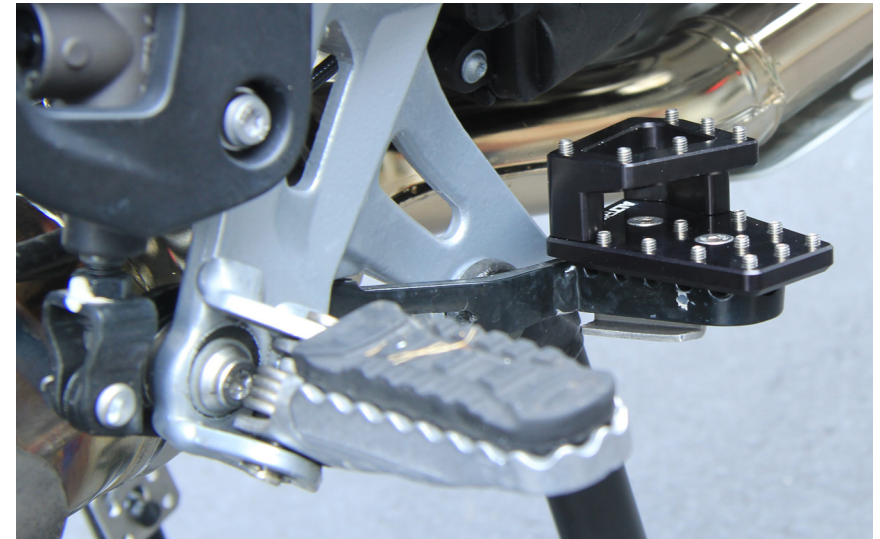

- ⑧ Confirm brake lever action. If there is any interference, binding, or if the lever does not return to its position, -reset to factory specs and make sure you full system is operating correctly before attempting to adjust again. (shown with DualControl installed).

CONGRATULATIONS!

You've completed your installation. If at any point you have questions about your installation or have any feed back for us, we'd love to hear it. A downloadable version of these instructions can be found at our web site. www.AltRider.com

After 5 hours or 100 miles of riding, check your newly installed equipment to ensure all hardware is secure.

Global Office:

email: info@AltRider.com
phone: +1 206-922-3618
address: 4000 Aurora Ave N
Ste 100
Seattle, WA 98103

Europe

mailing: Heliumstraat 230
2718 RS Zoetermeer
Netherlands
email: info@altrider.eu
web: www.altrider.eu

TERMS OF USE, WARRANTY AND LIABILITY WAIVER

AltRider LLC, a Washington company, having its principal place of business in Seattle, WA ("AltRider") offers its motorcycle accessories (the "Product") with the terms, conditions and notices as follows:

Terms of Use

This Product is offered to you conditioned upon your acceptance without modification of the terms, conditions, and notices contained herein. Installation and/or use of this product implies acceptance of all such terms, conditions, and notices. If you do not agree to these terms, do not buy the Product. If you have already bought the Product and do not agree to these terms, return this Product promptly including the packaging and all written materials, to AltRider.

Limitation of Liability and Warranty Disclaimer

You may return your merchandise for a full refund or exchange, less any original or return shipping fees under these conditions:

1. Only if the merchandise is in 100% factory condition. Original manufacturer's packaging and same condition as sold – original boxes, packaging material, instructions, documentation, parts, and attached tags.

2. Only unused, unscratched, uninstalled, undamaged merchandise will be accepted. Do not install equipment until you are sure you want to keep it. Package items carefully in protective materials before returning them. Never ship an item in its original manufacturers packaging – it will arrive damaged. Please use a postal box or other adequate packaging to ensure your return or exchange is not damaged on the way back to AltRider.com.

To read more about our exchanges and returns policy, on the web, navigate to <http://www.altrider.com/info/exchangesAndReturns>

Excepting the warranties stated in the preceding paragraph, AltRider hereby disclaims all other warranties and conditions with regard to the Product including all implied warranties and conditions of merchantability and fitness for a particular purpose. There are no warranties which extend beyond the description on the face hereof. AltRider does not warrant against damages or defects arising out of use or installation of the Product. Installation instructions are provided for your convenience. AltRider is not responsible for any damages arising out of the installation, improper or otherwise, of the Product. No warranty of any kind, expressed or implied, is made regarding the safety of this Product.

To the extent allowed by law, AltRider shall not be held liable for any direct, indirect, punitive, incidental, special or consequential damages arising out of, or connected with, the use or misuse of this Product. Buyer assumes all risks and liability arising from use of this Product.

Entire Agreement

This document states the entire obligation of AltRider with respect to the Product. If any part of this agreement is determined to be void, invalid, unenforceable or illegal, including, but not limited to the warranty disclaimers and liability limitations set forth above, then the remainder of the agreement shall remain in full force and effect.

Applicable Law

This agreement is governed by the laws of Washington, USA. You hereby consent to the exclusive jurisdiction and venue of the courts of Washington, USA, in all disputes arising out of or relating to the use of this product.

