



# AltRider Skid Plate for BMW S 1000 XR INSTALLATION INSTRUCTIONS

The most up to date instructions can be downloaded from the product page at [altrider.com](http://altrider.com), under the instructions tab.

Dear Rider,  
Thank you for choosing AltRider! Whether a seasoned world adventurer or a first time ADV-Newbie, we welcome you to the AltRider experience. You can install your new product with the utmost confidence. AltRider designs, tests, and manufactures all of its products here in the United States. We are proud to do what we do, and honored to present to you the product of our labors.

Enjoy it, show it off, and most of all, RIDE IT!

Venture On,  
Jeremy LeBreton

**A**  
**ALTRIDER**  
venture on  
**Skid Plate**  
**for the**  
**BMW S1000 XR**

Package Contents:  
-skid plate  
-hardware  
-brackets



## AltRider LLC

### Global

mailing: 4000 Aurora Ave N Ste 100  
Seattle, WA 98103 USA  
phone: 206-922-3618  
email: [info@altrider.com](mailto:info@altrider.com)  
web: [www.altrider.com](http://www.altrider.com)

### Europe

mailing: Heliumstraat 230  
2718 RS Zoetermeer  
The Netherlands  
email: [info@altrider.eu](mailto:info@altrider.eu)  
web: [www.altrider.eu](http://www.altrider.eu)

Rev 4.0  
MADE IN THE USA



**Skid Plate Contents**

- ① Right front bracket
- ② Left front bracket
- ③ Right rear bracket
- ④ Left rear bracket
- ⑤ Skid plate
- ⑥ (x8) M6 finishing washer
- ⑦ (x8) M6x16 flat head fastener

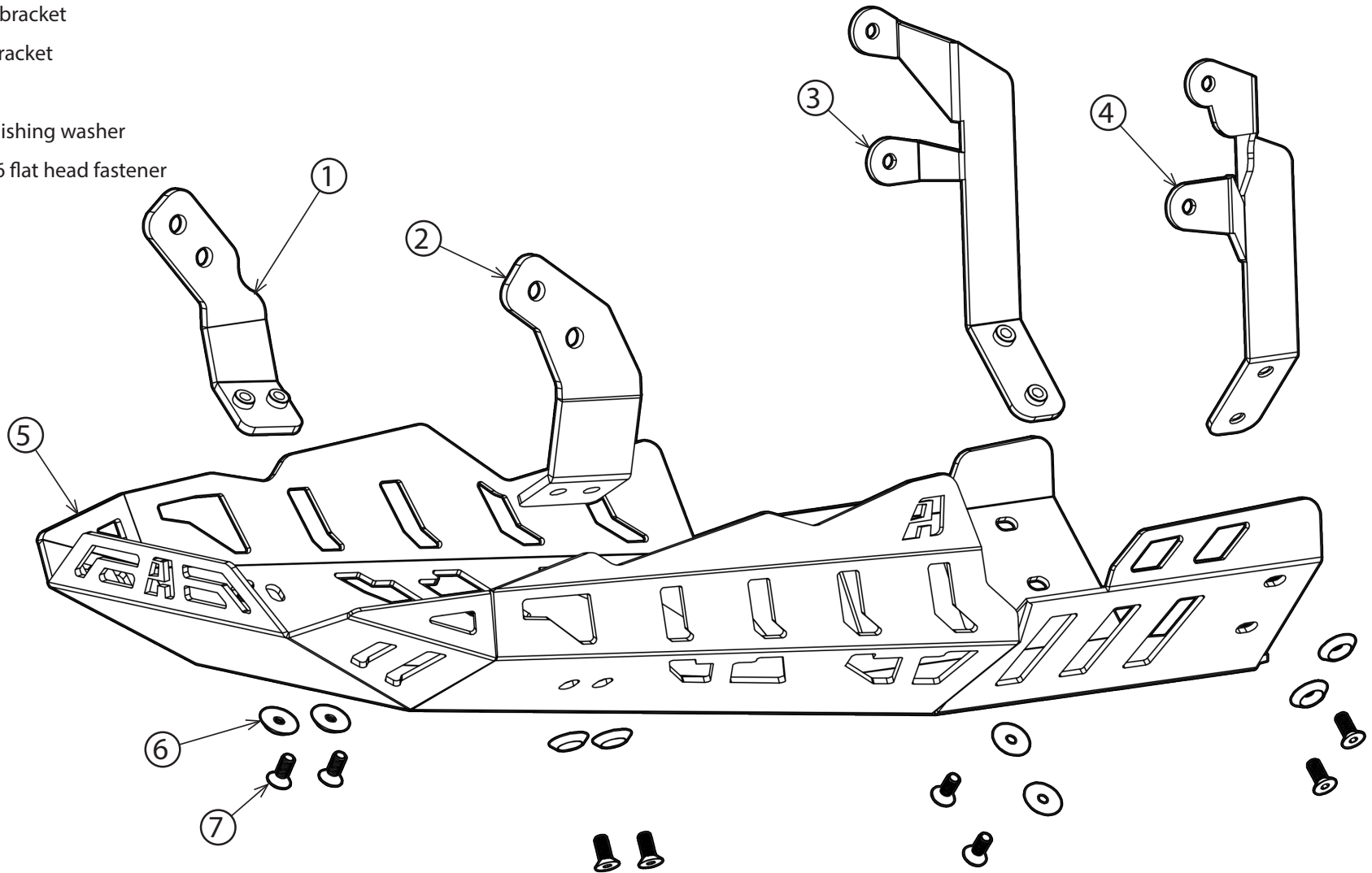

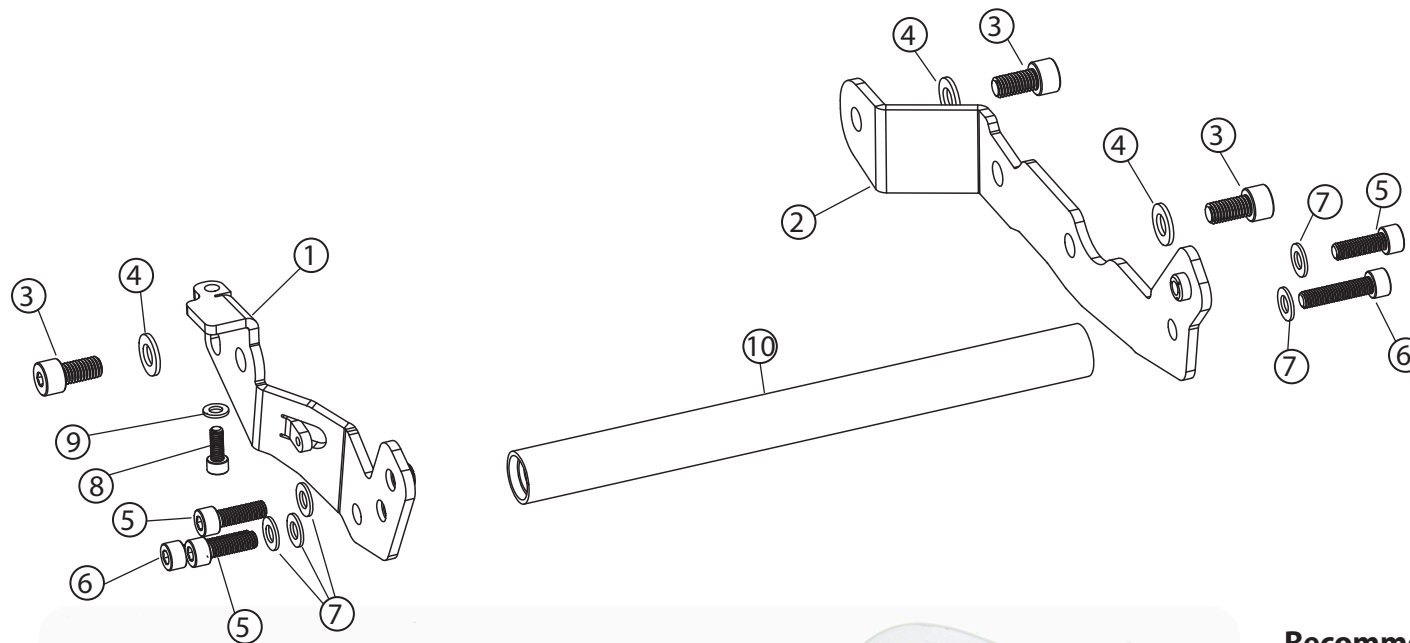

### Crash Bar and Skid Plate Mounting Bracket Kit Contents

- ① Bracket Right side
- ② Bracket Left side
- ③ (3) M10 x 20 socket cap screw
- ④ (3) M10 washer
- ⑤ (3) M8 x 25 socket cap screw
- ⑥ (2) M8 x 35 socket cap screw
- ⑦ (5) M8 washers ss
- ⑧ M6 x 16 socket cap screw
- ⑨ M6 washer ss
- ⑩ Cross tube

### Recommended tools:

- ① [Torque wrench](#)
- ② [1/2" \(or 3/8"\) ratchet](#)
- ③ [1/4" ratchet](#)
- ④ 1/4" extension/driver
- ⑤ [spring puller](#)
- ⑥ 4mm allen
- ⑦ t30 torx
- ⑧ t25 torx
- ⑨ 1/2" (or 3/8") extension
- ⑩ 13mm socket
- ⑪ 5mm allen
- ⑫ 6mm allen
- ⑬ 8mm allen
- ⑭ t40 torx
- ⑮ medium strength thread locker





① **A If you already have the AltRider S 1000 XR Crash Bars installed:**

Remove (2) front M8 screws that connect them to the front leg of the brackets. The rear bracket bolts can remain attached to the bike and bars.

② **B If you are installing the AltRider S 1000 XR Skid Plate at the same time as the crash bars:**

A) Start with the crash bars instructions and install the crash bars first.

B) You will be prompted to pause and install the skid plate part way through.

③ **C If you are installing the AltRider S 1000 XR Skid Plate only:**

Proceed with these instructions to complete your install.

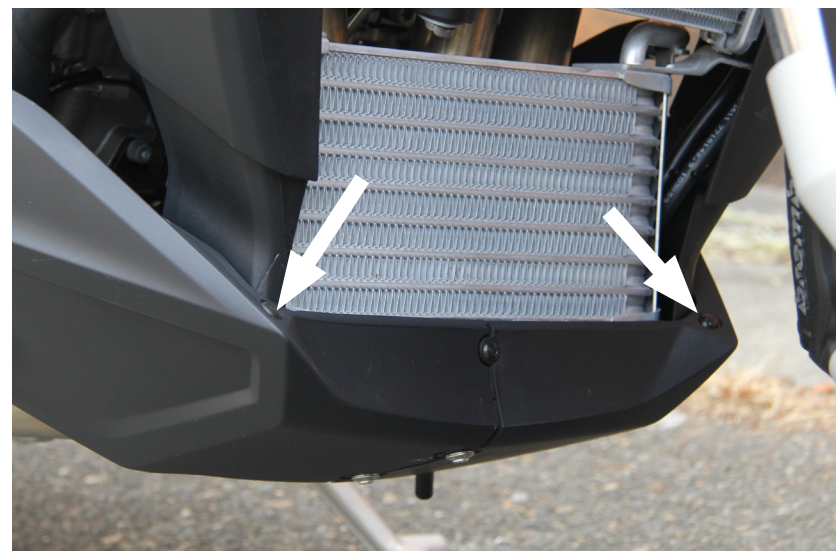

- ② Remove plastic lower fairing. Start by detaching the small plastic rivet at each front corner. Push the small central pin inward. Caution, watch where it goes inside the fairing! Then pull the head of the plastic rivet outwards. Save these parts and store them with the plastic lower fairing, you will not be re-using these parts.

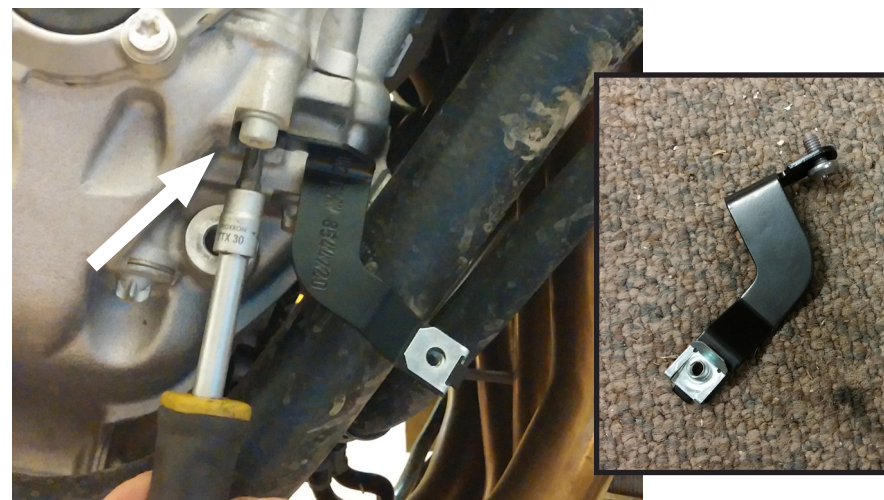
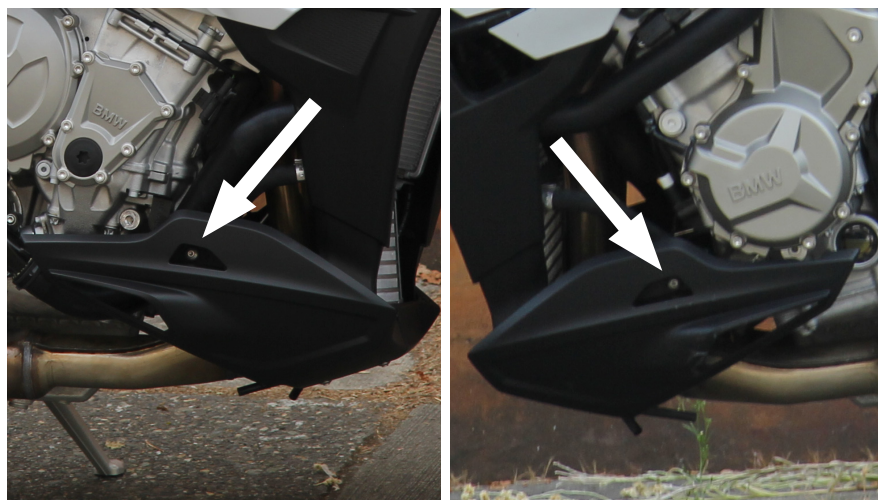

- ③ Use a T25 torx bit and remove the two screws (one right side, one left) that attach the lower fairing. Save these for reinstallation. Remove the fairing and locate small plastic pins from step 2. Save all for reinstallation.

- ④ Use a T-30 torx tool to remove the right side bracket that holds the lower fairing, you will not reuse these parts.



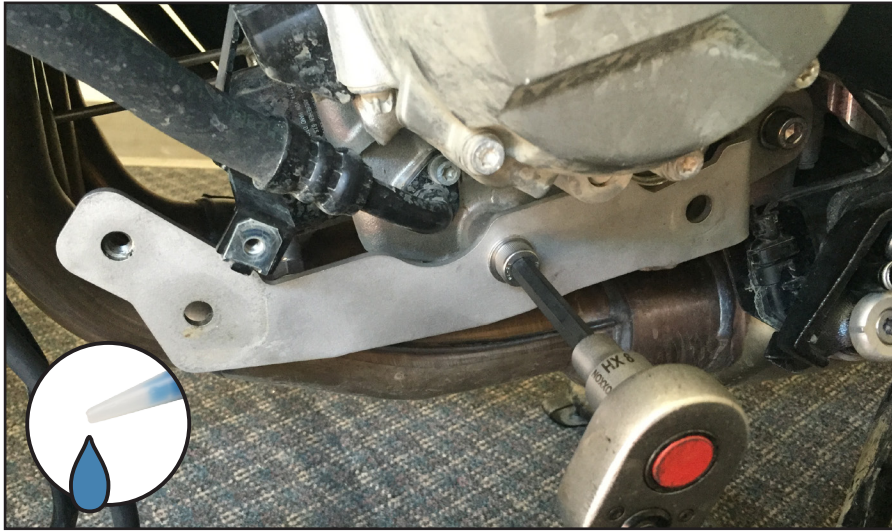

- ⑤ Start with the left side mounting bracket and align as shown. After applying blue thread locker to the last couple of threads on each of the (2) M10 x 20 fasteners with M10 washers, use a 8mm allen tool to attach the bracket to the bike as shown. Do not tighten the fasteners all the way down, leave the bracket loose so that you can adjust it.

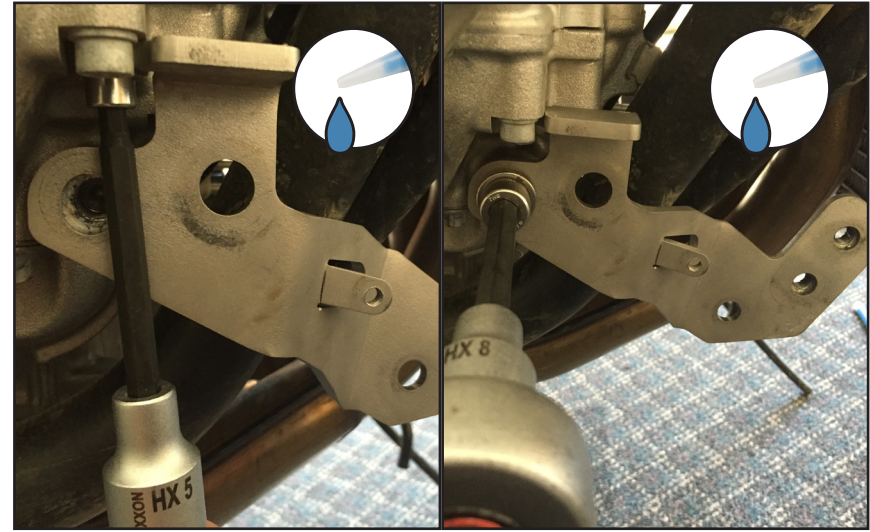

- ⑥ The right side mounting bracket will essentially take the place of the OEM bracket you removed in step 4. **(A)** After applying thread locker to the fasteners, use a 5mm allen tool to get the (1) M6 x 16 bolt and M6 washer started first, do not tighten it down yet. **(B)** Next, using a 6mm allen tool, get the (1) M10 x 20 bolt with M10 washer started in the location shown. Do not tighten all the way yet.

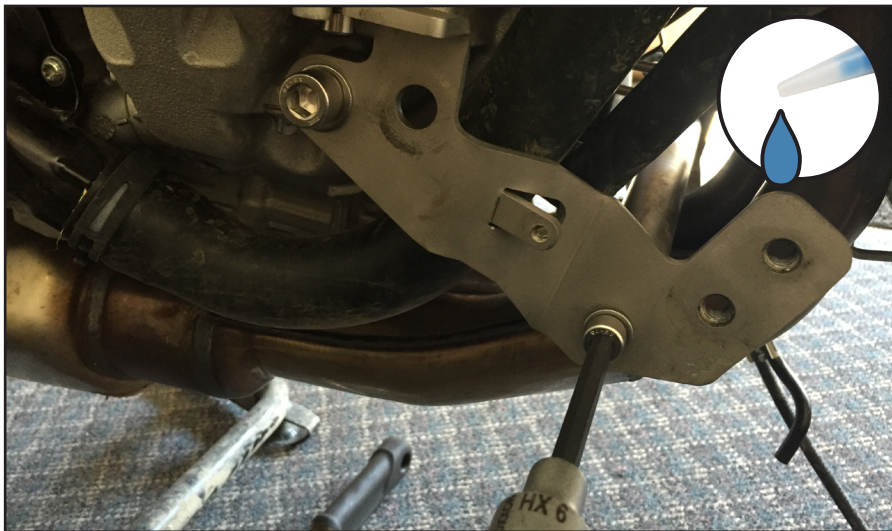

- ⑦ Install the mounting bracket cross-tube. Apply thread locker to each fastener. Each side uses one M8 x 35 socket cap bolt. Attach the right side first, but leave it loose, do not tighten all the way yet.

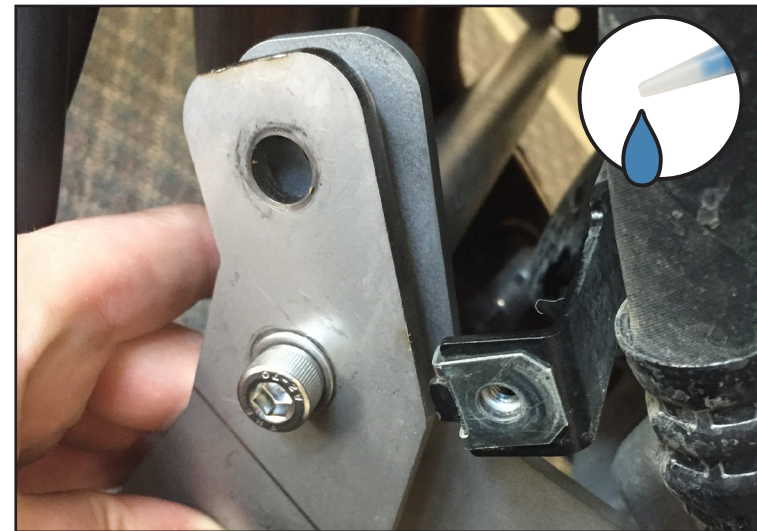

- ⑧ Now on the left side position the front left skid plate bracket as shown, and **(A)** insert the M8 x 35 fastener with M8 washer as shown. **(B)** Next insert the M8 x 25 fastener with M8 washer as shown, do not tighten all the way yet.



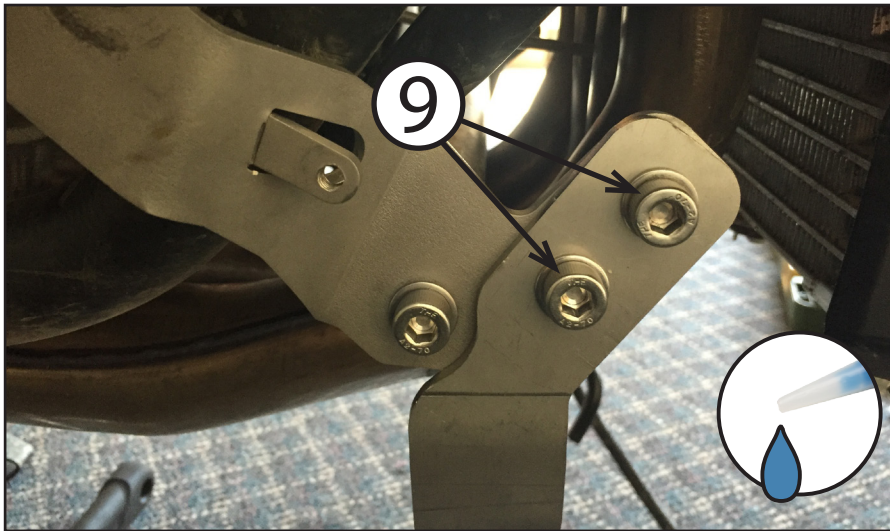

- ⑨ Position the right front skid plate bracket as shown. After applying thread locker to both fasteners, use a 6mm allen tool to install the (2) M8 x 25 fasteners with washers as shown. Do not tighten all the way yet, you want the bracket to have a generous amount of adjustability.

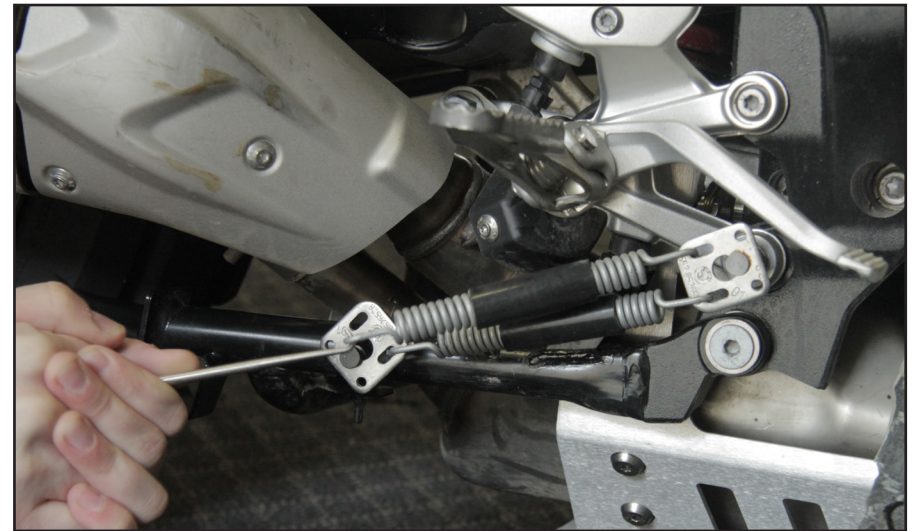

- ⑩ Place your bike on its side stand temporarily. Use a spring-puller to release the center stand return springs, do them one at a time. Put the bike back up on the center stand. Verify the bike is stable, do not do this step on an incline.

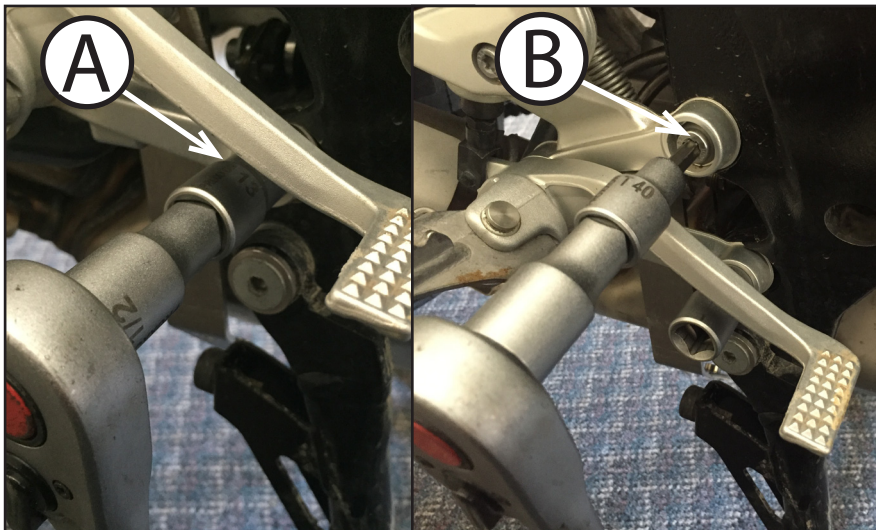

- ⑪ **(A)** Using a 15mm socket, remove the pin which the springs were attached to, you will be reusing this pin so keep it close. **(B)** Next use a T45 torx tool to remove the upper bolt as shown. Place the right rear skid plate bracket as shown and use the (2) OEM bolts you just removed to secure it, leave loose for now.

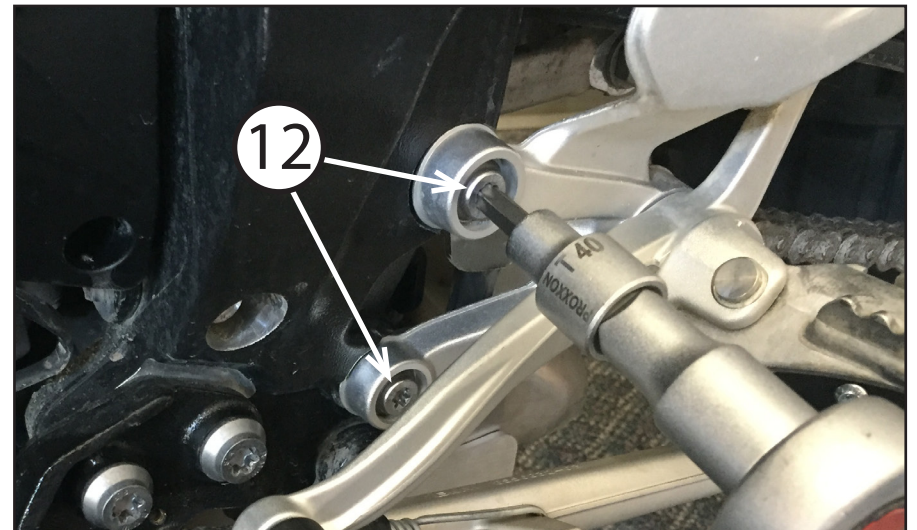

- ⑫ On the left side of the bike, use a T45 torx tool to remove the (2) OEM bolts from the left rearset. Align the left rear skid plate bracket as shown and reinsert the (2) OEM bolts as shown, leave loose for now.





- ⑬ Now that all of the brackets are in place, hold your skid plate up and get a sense of how it will be fastened. It is recommended to start with the rear brackets. After applying thread locker to them, use a 4mm allen tool to get the (2) M6 x 15 flat head fastener with finishing washer started on one side. Leave them loose as you have on all the other fasteners. Now do the other side.



- ⑭ The skid plate should be hanging in place at this point. Use your 4mm allen tool to continue to install the front (4) M6 x 15 flat head fasteners with finishing washers on the left and right front skid plate brackets to finish attaching the skid plate. You may need to move the front right or left brackets a little by hand to get the holes to line up properly. Once you have all (8) OEM fasteners {(4) in front and (4) in the rear} started move on to step



- ⑮ Now tighten each of the fasteners down starting with the flat head M6s which you can tighten until snug. Finish with the main mounting brackets' M10s, tighten to 40nm. Tighten the M8s the t40s and the center stand pin to 25nm. Take the bike off of the center stand and put it back on the side stand. Use a block of wood to prop the center stand up to assist with installing the springs.

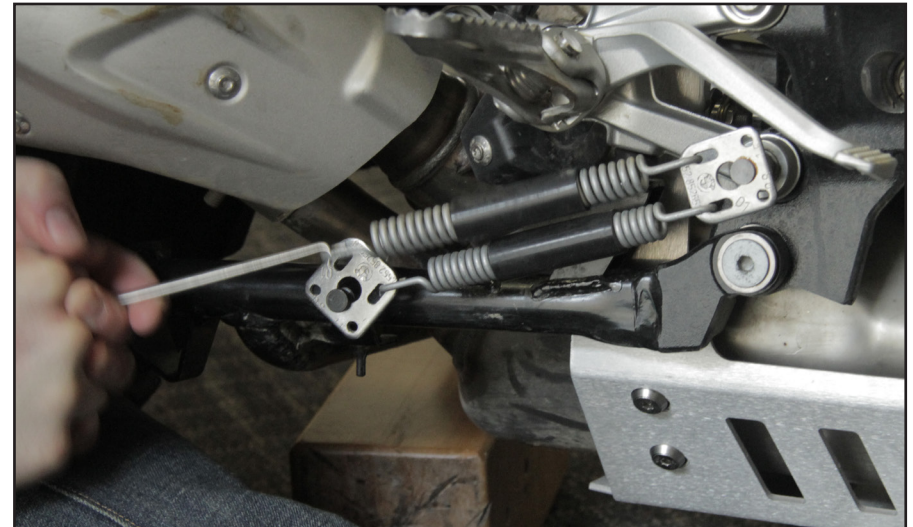

- ⑯ Place the spring hanger plate back on the pin and hang the springs. Using the spring puller tool, pull one spring and then another and hook them on to the plate as shown. The wood block holds the stand up so that you pull backward, instead of down which has limited space.

## CONGRATULATIONS!

**You've completed your installation. If at any point you have questions about your installation or have any feed back for us, we'd love to hear it. A downloadable version of these instructions can be found at our web site. [www.AltRider.com](http://www.AltRider.com)**

**After 5 hours of riding, or 100 miles, check all the fasteners on the assembly to ensure they are tightened to spec.**

### Global Office:

**email: info@AltRider.com**  
**phone: +1 206-922-3618**  
**address: 4000 Aurora Ave N**  
**Ste 100**  
**Seattle, WA 98103**

### Europe Office:

**email: info@AltRider.eu**  
**address: AltRider EU**  
**Heliumstraat 230**  
**2718 RS Zoetermeer**  
**The Netherlands**

#### TERMS OF USE, WARRANTY AND LIABILITY WAIVER

AltRider LLC, a Washington company, having its principal place of business in Seattle, WA ("AltRider") offers its motorcycle accessories (the "Product") with the terms, conditions and notices as follows:

##### Terms of Use

This Product is offered to you conditioned upon your acceptance without modification of the terms, conditions, and notices contained herein. Installation and/or use of this product implies acceptance of all such terms, conditions, and notices. If you do not agree to these terms, do not buy the Product. If you have already bought the Product and do not agree to these terms, return this Product promptly including the packaging and all written materials, to AltRider.

##### Limitation of Liability and Warranty Disclaimer

You may return your merchandise for a full refund or exchange, less any original or return shipping fees under these conditions:

1. Only if the merchandise is in 100% factory condition. Original manufacturer's packaging and same condition as sold – original boxes, packaging material, instructions, documentation, parts, and attached tags.
2. Only unused, unscratched, uninstalled, undamaged merchandise will be accepted. Do not install equipment until you are sure you want to keep it. Package items carefully in protective materials before returning them. Never ship an item in its original manufacturers packaging – it will arrive damaged. Please use a postal box or other adequate packaging to ensure your return or exchange is not damaged on the way back to AltRider.com.

To read more about our exchanges and returns policy, on the web, navigate to <http://www.altrider.com/info/exchangesAndReturns>

Excepting the warranties stated in the preceding paragraph, AltRider hereby disclaims all other warranties and conditions with regard to the Product including all implied warranties and conditions of merchantability and fitness for a particular purpose. There are no warranties which extend beyond the description on the face hereof. AltRider does not warrant against damages or defects arising out of use or installation of the Product. Installation instructions are provided for your convenience. AltRider is not responsible for any damages arising out of the installation, improper or otherwise, of the Product. No warranty of any kind, expressed or implied, is made regarding the safety of this Product.

To the extent allowed by law, AltRider shall not be held liable for any direct, indirect, punitive, incidental, special or consequential damages arising out of, or connected with, the use or misuse of this Product. Buyer assumes all risks and liability arising from use of this Product.

##### Entire Agreement

This document states the entire obligation of AltRider with respect to the Product. If any part of this agreement is determined to be void, invalid, unenforceable or illegal, including, but not limited to the warranty disclaimers and liability limitations set forth above, then the remainder of the agreement shall remain in full force and effect.

##### Applicable Law

This agreement is governed by the laws of Washington, USA. You hereby consent to the exclusive jurisdiction and venue of the courts of Washington, USA, in all disputes arising out of or relating to the use of this product.

