



AltRider Lower Crash Bars for Honda Africa Twin CRF1000L INSTALLATION INSTRUCTIONS

The most up to date instructions can be downloaded from the product page at altrider.com, under the instructions tab.

Dear Rider,
Thank you for choosing AltRider! Whether a seasoned world adventurer or a first time ADV-Newbie, we welcome you to the AltRider experience. You can install your new product with the utmost confidence. AltRider designs, tests, and manufactures all of its products here in the United States. We are proud to do what we do, and honored to present to you the product of our labors.

Enjoy it, show it off, and most of all, RIDE IT!

Venture On,
Jeremy LeBreton

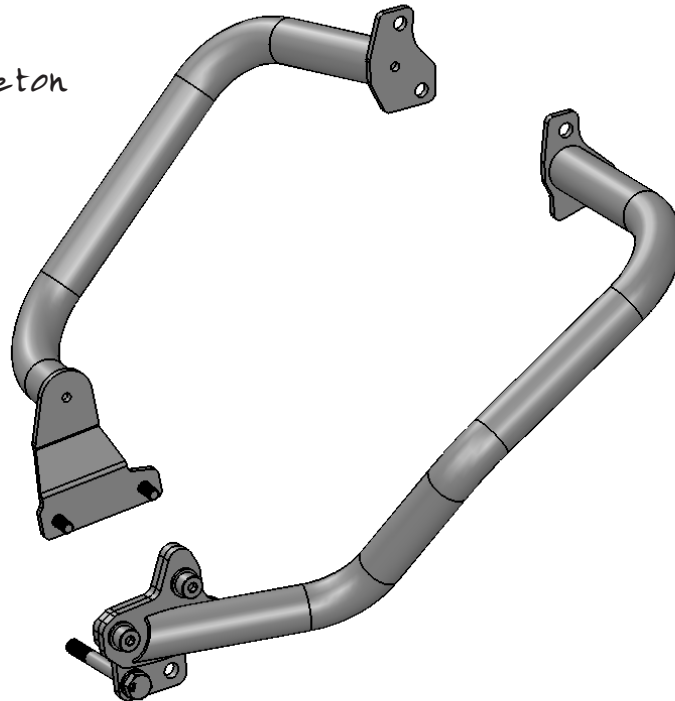

**AltRider Lower Crash Bars
Honda Africa Twin CRF1000L**

Package Contents:

- Crash Bars
- Hardware Kit
- Instructions

AltRider LLC

Global

mailing: 4000 Aurora Ave N Ste 100
Seattle, WA 98103 USA
phone: 206-922-3618
email: info@altrider.com
web: www.altrider.com

Europe

mailing: AltRider EU
Heliumstraat 230
2718 RS Zoetermeer
The Netherlands

email: info@altrider.eu

**REV 14.3
MADE IN THE USA**

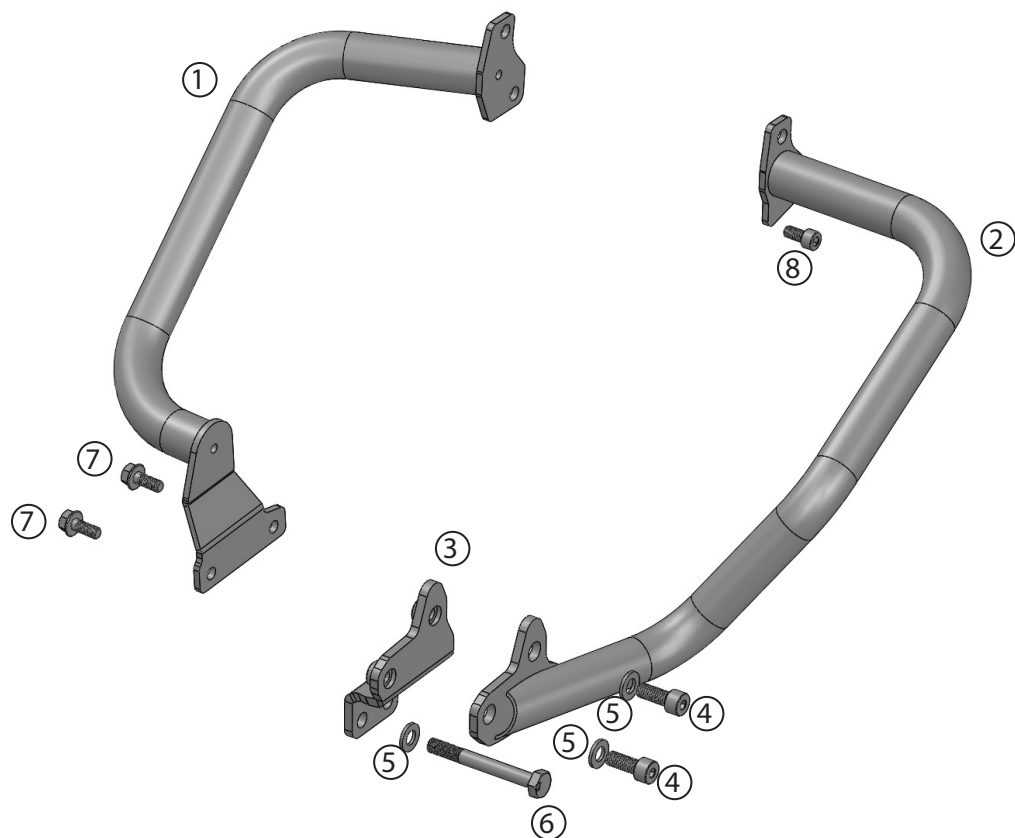

**Kit:**

- ① Left bar
- ② Right bar
- ③ Right rear bracket
- ④ (qty 2) M10 x 25 socket cap screw
- ⑤ (qty 3) M10 washer
- ⑥ M10 x 85 x 1.25 hex screw
- ⑦ (qty 2) M8 x 20mm hex flange screws
- ⑧ M8 x 16 socket cap screw

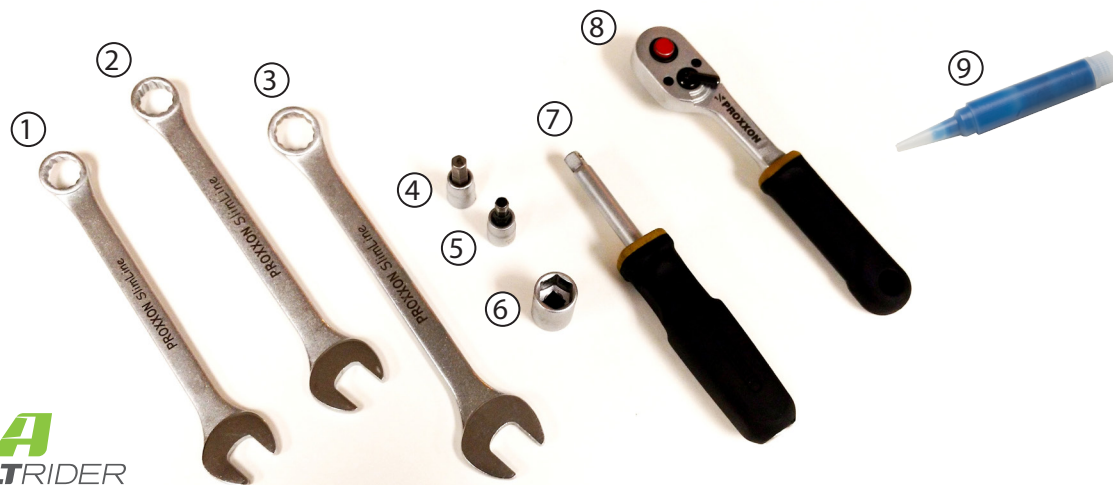
**Required Tools:**

- ① 12mm spanner
- ② 14mm spanner
- ③ 14mm spanner
- ④ 8mm hex allen tool
- ⑤ 6mm hex allen tool
- ⑥ 12mm socket
- ⑦ Extension
- ⑧ Ratchet
- ⑨ Thread locker



Install the **Bracket Set AT16-9-1000** before installing either the lower or upper crash bars.



- ① Depress locking tabs and unfasten the small clip that holds the oxygen sensor wire to the fill reservoir (located near the rear brake pedal).

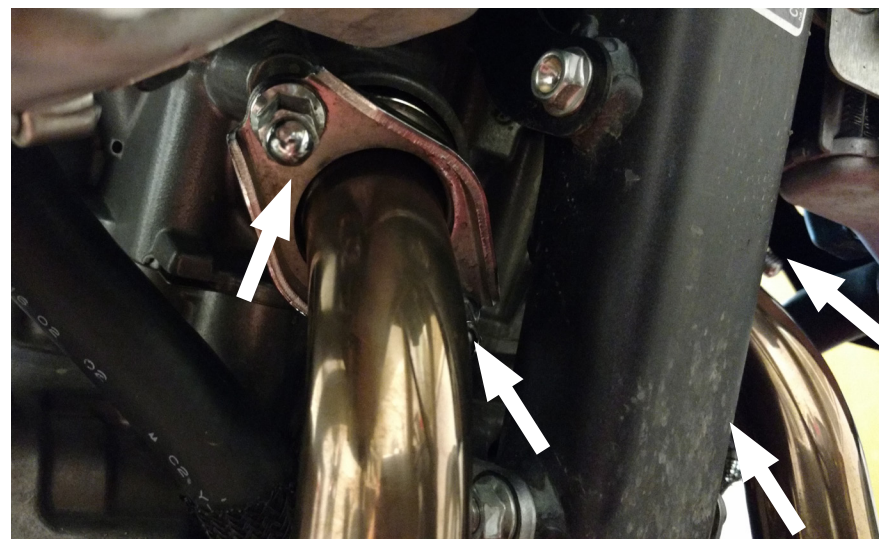

- ② Use 12mm socket with extension, loosen the four (4) acorn nuts that hold the exhaust header flanges. Do not remove completely, but make very loose.

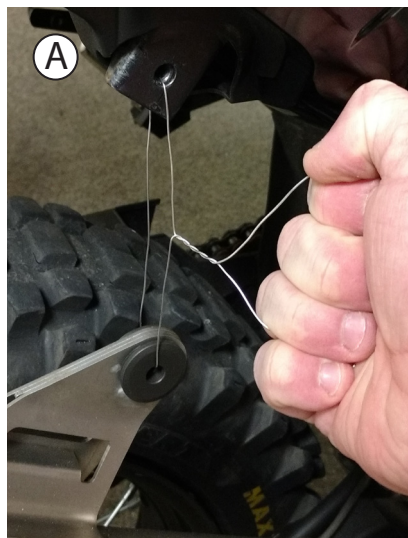

- ③ Use 6mm allen tool and remove the screw that holds the exhaust canister. Prepare a loop of safety wire or zip ties, or some other method of hanging the exhaust from this mounting point. (A) A section of safety wire can be twisted as shown and used to take up any slack.



- ④ Use 12mm spanner and socket and remove the lower exhaust hanging bolt. The entire loosened system will now hang slightly lower.

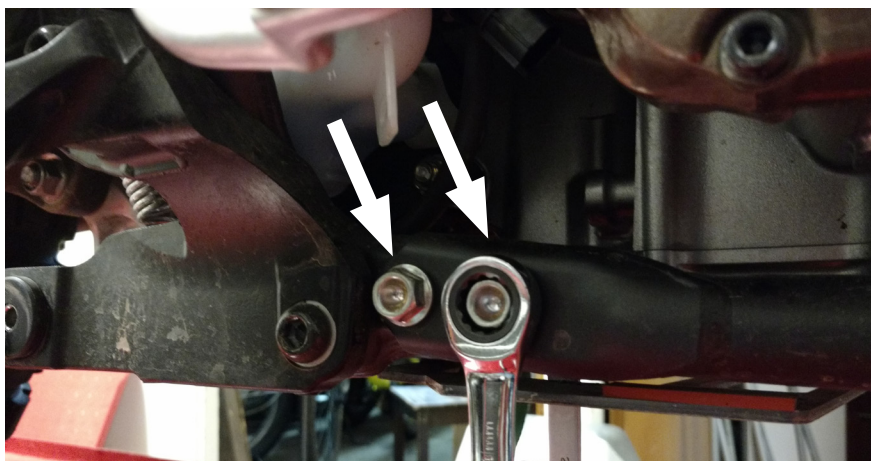

- ⑤ Use 14mm spanners to loosen both frame rail M10 screws and nuts.



- ⑥ Remove both screws. discard the forward, shorter (60mm) screw, but keep the nut. !!TIP If removing the screws is difficult, wrap a screwdriver or small pry bar with cloth and lever the frame rail downward to release the pressure on the screw.

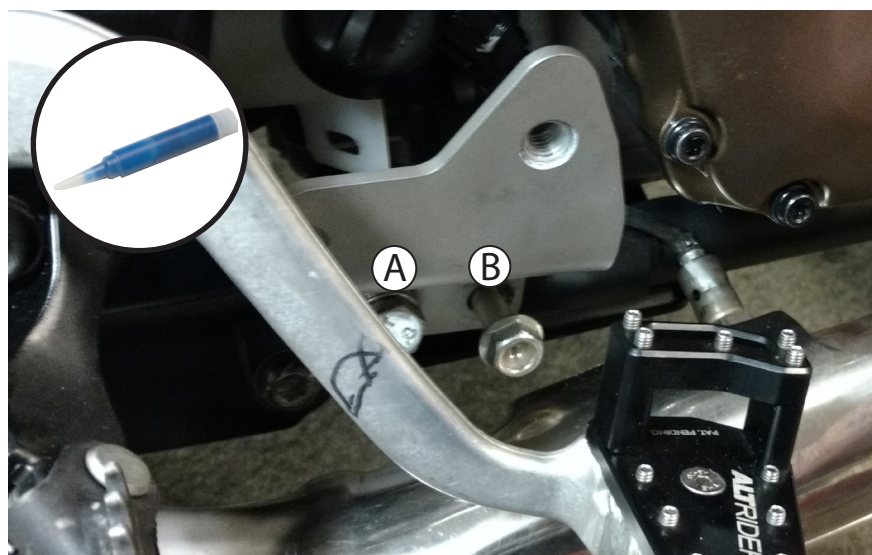

- ⑦ Install the Right Rear bracket.
If you are installing the AltRider Skid Plate, pause and install the skid plate rear mounting bracket now (it also uses these mounting bolts).
 Use a drop of thread locker on each screw.
 (A) Use the included AltRider M10 x 85mm screw in the rear position.
 (B) Use the OEM Honda M10 x 75mm screw in the forward position.
 Thread on the M10 nuts, but leave loose for now.



- ⑧ Inspect headers for blow by (not likely) and replace gaskets if worn. Reinstall exhaust, (steps 1 -5 in reverse order.) Don't forget to clip the o2 sensor wire in place. TECH TIP: The gaskets can be annealed by removing each and heating to cherry red to anneal and allow re-use.

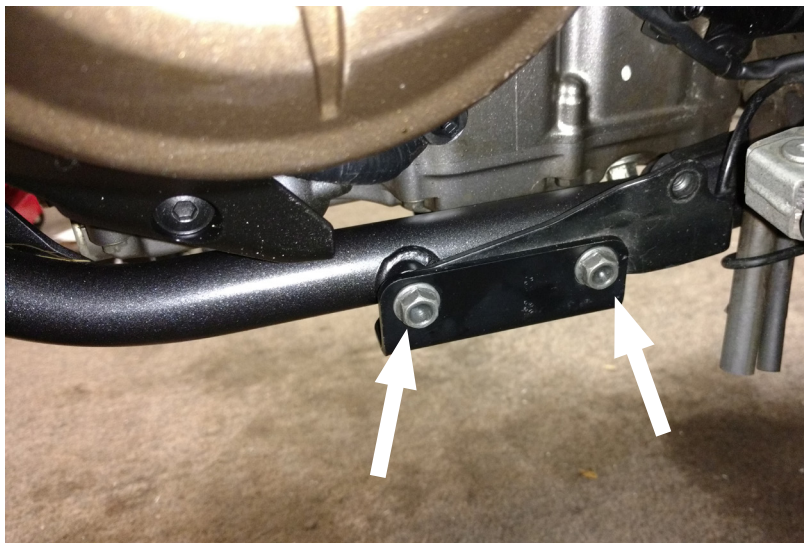

- ⑨ Remove two (2) M8 hex cap screws from the left rear frame rail. (If AltRider skid plate bracket is already installed, leave it in place).

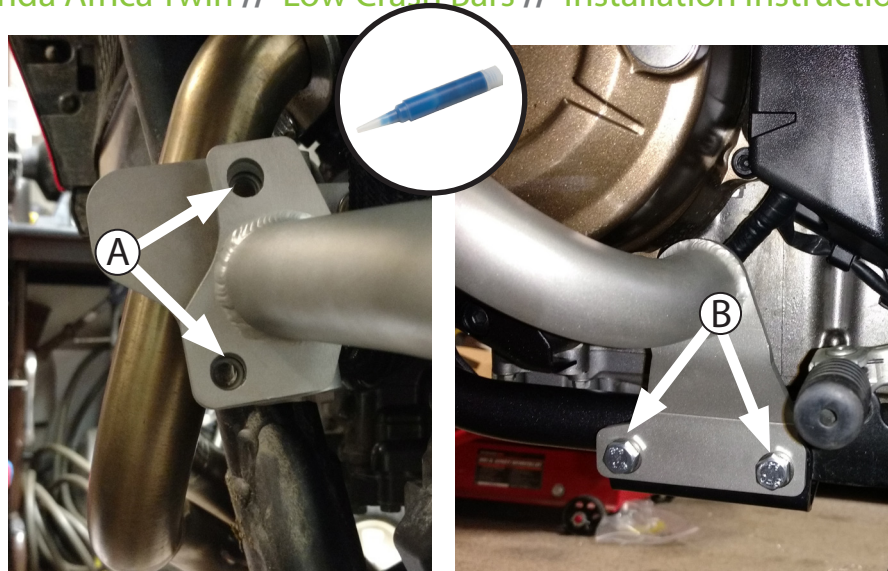

- ⑩ Install Left bar. Add a drop of thread locker to each screw before installation. (A) Use two M8 x 25 socket cap screws at the front (supplied with Bracket Set kit). (B) Use two M8 x 25 hex cap screws at the rear (supplied with Crash Bar kit). Tighten all M8 screws to 23Nm.

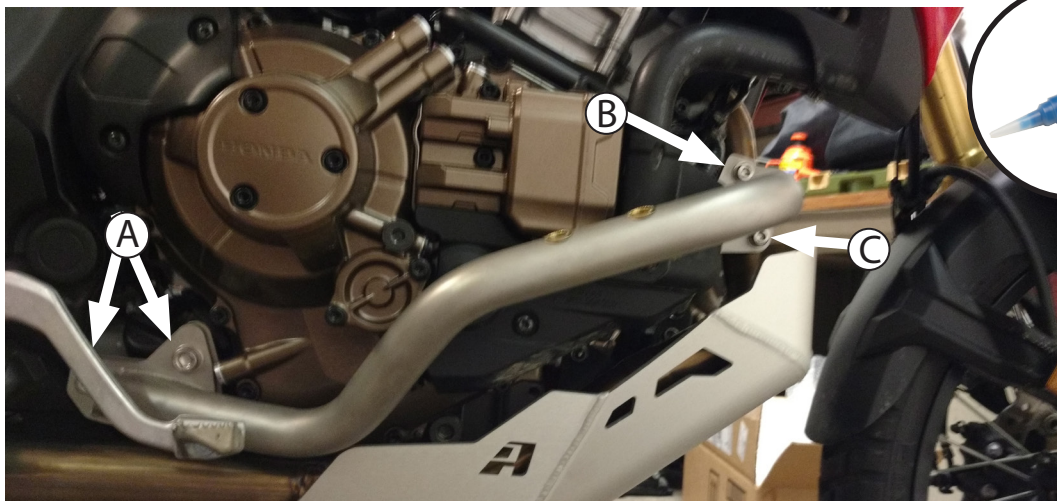

- ⑪ Attach right side crash bar. Place a drop of thread locker onto each screw. (A) Use two M10 x 25 socket cap screws with washers at the rear (supplied with Crash Bar kit) (B) Use one M8x25 socket cap screw with washer in upper location. (C) If installing Low Bars only, use M8 x 16 socket cap screw with washer. If installing Lower and Upper bars, you will use the longer M8 x 25mm socket cap screw here. (do not tighten until upper bar flange in place).

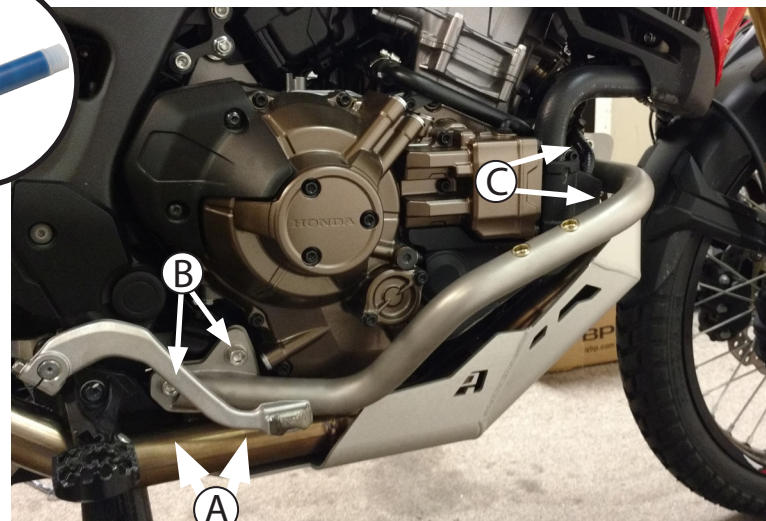

- ⑫ (A) Tighten the M10 hex cap frame screws to 49Nm. (B) Tighten the M10 socket cap screws to 40Nm. (C) Tighten M8 socket cap screws to 23Nm.

CONGRATULATIONS!

You've completed your installation. If at any point you have questions about your installation or have any feed back for us, we'd love to hear it. A downloadable version of these instructions can be found at our web site. www.AltRider.com

After 5 hours of riding, or 100 miles, check all the fasteners on the assembly to ensure they are tightened to spec.

Global Office:

email: info@AltRider.com
phone: +1 206-922-3618
address: 4000 Aurora Ave N
Ste 100
Seattle, WA 98103

Europe Office:

email: info@AltRider.eu
address: AltRider EU
Heliumstraat 230
2718 RS Zoetermeer
The Netherlands

TERMS OF USE, WARRANTY AND LIABILITY WAIVER

AltRider LLC, a Washington company, having its principal place of business in Seattle, WA ("AltRider") offers its motorcycle accessories (the "Product") with the terms, conditions and notices as follows:

Terms of Use

This Product is offered to you conditioned upon your acceptance without modification of the terms, conditions, and notices contained herein. Installation and/or use of this product implies acceptance of all such terms, conditions, and notices. If you do not agree to these terms, do not buy the Product. If you have already bought the Product and do not agree to these terms, return this Product promptly including the packaging and all written materials, to AltRider.

Limitation of Liability and Warranty Disclaimer

You may return your merchandise for a full refund or exchange, less any original or return shipping fees under these conditions:

1. Only if the merchandise is in 100% factory condition. Original manufacturer's packaging and same condition as sold – original boxes, packaging material, instructions, documentation, parts, and attached tags.

2. Only unused, unscratched, uninstalled, undamaged merchandise will be accepted. Do not install equipment until you are sure you want to keep it. Package items carefully in protective materials before returning them. Never ship an item in its original manufacturers packaging – it will arrive damaged. Please use a postal box or other adequate packaging to ensure your return or exchange is not damaged on the way back to AltRider.com.

To read more about our exchanges and returns policy, on the web, navigate to <http://www.altrider.com/info/exchangesAndReturns>

Excepting the warranties stated in the preceding paragraph, AltRider hereby disclaims all other warranties and conditions with regard to the Product including all implied warranties and conditions of merchantability and fitness for a particular purpose. There are no warranties which extend beyond the description on the face hereof. AltRider does not warrant against damages or defects arising out of use or installation of the Product. Installation instructions are provided for your convenience. AltRider is not responsible for any damages arising out of the installation, improper or otherwise, of the Product. No warranty of any kind, expressed or implied, is made regarding the safety of this Product.

To the extent allowed by law, AltRider shall not be held liable for any direct, indirect, punitive, incidental, special or consequential damages arising out of, or connected with, the use or misuse of this Product. Buyer assumes all risks and liability arising from use of this Product.

Entire Agreement

This document states the entire obligation of AltRider with respect to the Product. If any part of this agreement is determined to be void, invalid, unenforceable or illegal, including, but not limited to the warranty disclaimers and liability limitations set forth above, then the remainder of the agreement shall remain in full force and effect.

Applicable Law

This agreement is governed by the laws of Washington, USA. You hereby consent to the exclusive jurisdiction and venue of the courts of Washington, USA, in all disputes arising out of or relating to the use of this product.

