



# BMW K1600 GT / GTL Engine Protection Bars INSTALLATION INSTRUCTIONS

The most up to date instructions can be downloaded from the product page at [altrider.com](http://altrider.com), under the instructions tab.

Dear Rider,  
Thank you for choosing Altrider! Whether a seasoned world adventurer or a first time ADV-Newbie, we welcome you to the Altrider experience. You can install your new product with the utmost confidence. Altrider designs, tests, and manufactures all of its products here in the United States. We are proud to do what we do, and honored to present to you the product of our labors.

Enjoy it, show it off, and most of all, RIDE IT!

Venture On,  
Jeremy LeBreton



## K1600 GT / GTL Engine Protection Bars

Package Contents:  
- left and right Engine Bars  
- hardware kit  
- instructions



---

## Altrider LLC

mailing: 4000 Aurora Ave N Ste 100  
Seattle, WA 98103 USA  
phone: 206-922-3618  
email: [info@altrider.com](mailto:info@altrider.com)  
web: [www.altrider.com](http://www.altrider.com)

Rev 0  
MADE IN THE USA



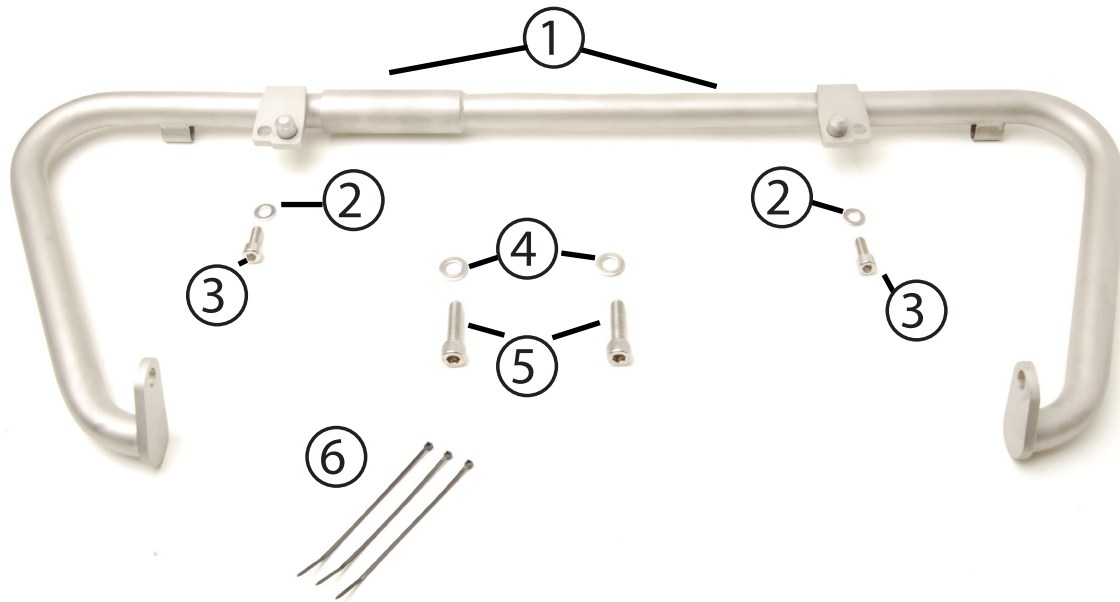

## Kit:

- ① L and R Engine Bars (pictured together)
- ② (2) M8 Stainless Steel Flat Washers
- ③ (2) M8 - 1.25 x 20 Socket Head Cap Screws
- ④ (2) M10 Stainless Steel Flat Washers
- ⑤ (2) M10 - 1.50 x 35 Socket Head Cap Screws
- ⑥ (3) Black Zip Ties

## Recommended tools:

- ① T25 Driver
- ② T30 Driver
- ③ T40 Driver
- ④ M8 Allen Driver or Allen Key
- ⑤ M6 Allen Driver or Allen Key
- ⑥ Long Nose Pliers / Flat Head Screwdriver
- ⑦ M10 Socket and/or wrench
- ⑧ Wire Cutters
- ⑨ Threadlocker
- ⑩ Small container or magnetic hardware tray





- ① On the GTL Model, first remove the Auxillary lights using a T30 driver and 10mm socket. Next clip the zip ties holding the power cord in place using wire cutters.



- ③ Remove the (4) bottom radiator cowl bolts using a T25 driver. There are (2) on each cowl.

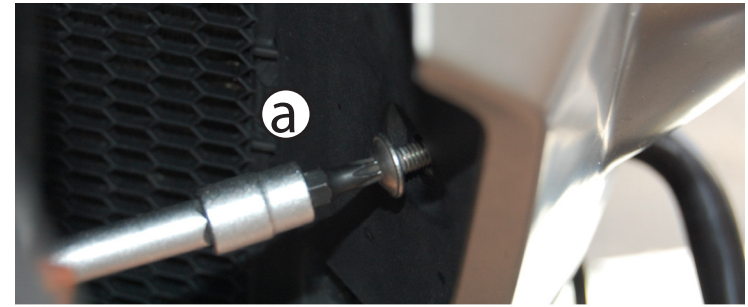

- ② Turn the front wheel completely to the right and remove the two front left radiator cowl screws, (A) top first, and (B) bottom second using a T25 driver. Turn the wheel to the left and repeat process with rightside.



- ④ Carefully remove the radiator cowl from each side of bike. Note that the top of each cowl has a locator pin that inserts into a rubber grommet. Take care so that this grommet does not fall out and get lost.



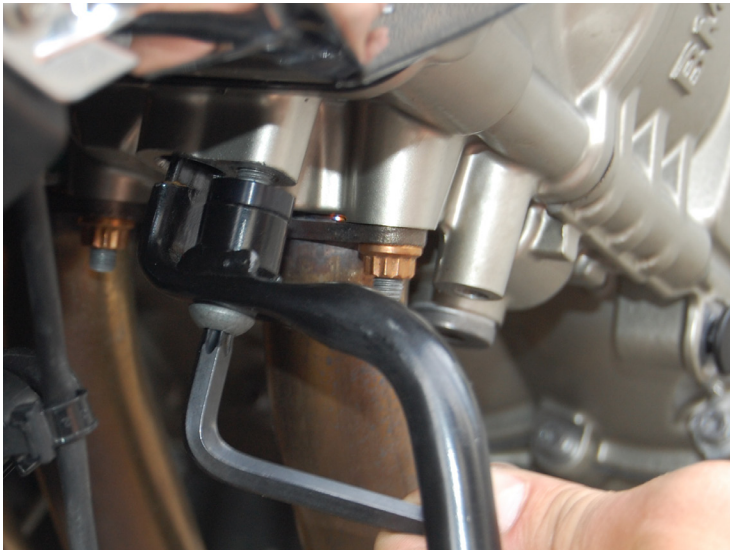

- ⑤ On GTL Model, remove the two Auxillary light brackets using a T40 driver. Be sure to save the bolts and spacers.



- ⑥ Carefully remove the black plastic plugs from the engine case on each side of the bike. The best way to remove these is by spinning counterclockwise like a bolt. If plugs are tight you can use needlenose pliers to start.

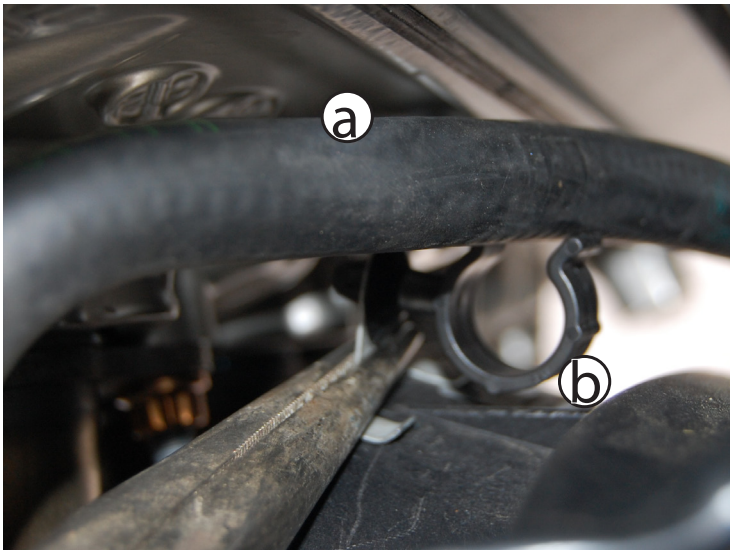

- ⑦ Using a long set of needlenose pliers or a flathead screwdriver, unseat the coolant hose (a) from the retaining clip (b). Remove the retaining clip from fan shroud by pushing back on it with pliers.

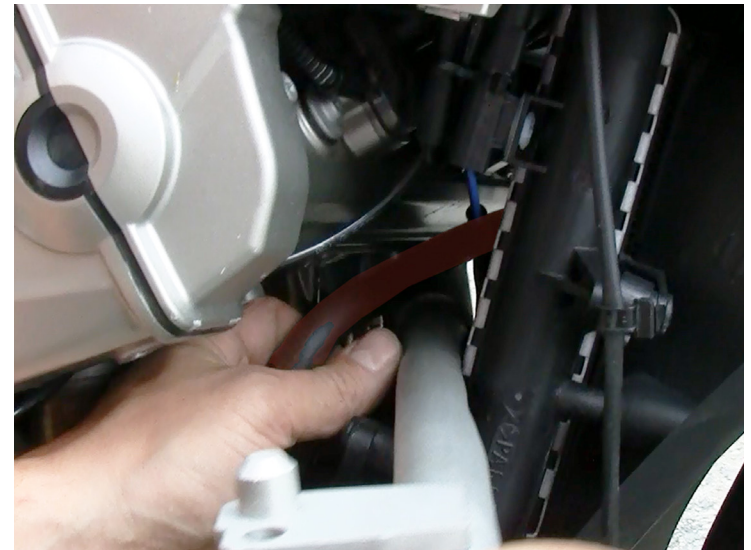

- ⑧ Install riders right side engine protection bar first. Slide the bar under the coolant hose. The coolant hose should be resting on top of the bar and be routed behind it.



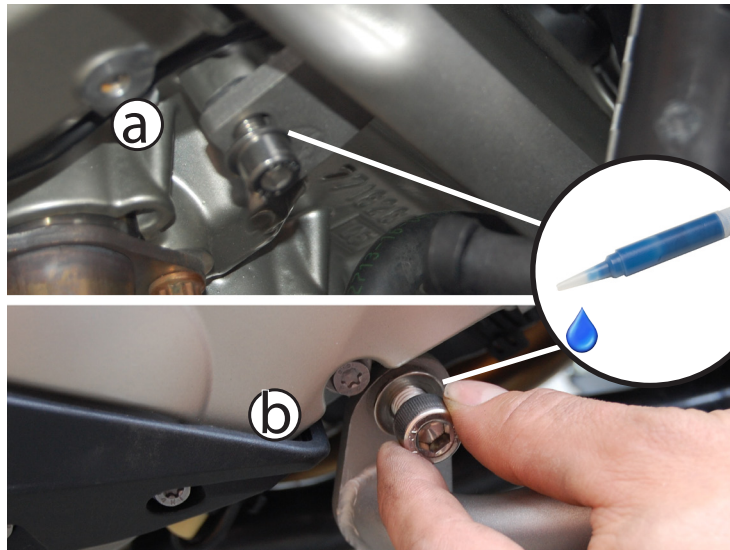

**IMPORTANT:**  
Before rolling the bars up  
ensure the coolant hose is  
not between the radiator  
and bar to allow an easy  
installation.

- ⑨ Start the upper M8 Allen Bolt (a) with washer. Next start the lower M10 bolt (b) with washer. Apply a few drops of threadlocker to each bolt before starting them. Bolts will be tightend later.



- ⑪ Now that all 4 fastners are started, you can go back around and tighten and torque fastners to correct spec. M8 x 20 = 19nm and M10 x 35 = 38nm or torque.

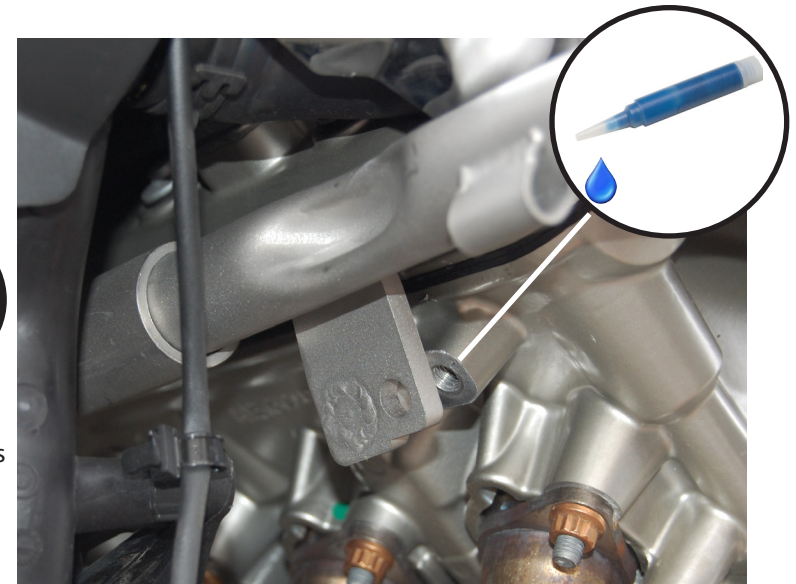

- ⑩ Slide the left side engine bar into the right side and swing the left bar up into position aligning the machined boss + bolt hole on engine case with engine bar mount. Start the M8 Allen bolt w/ washer and threadlocker. Start the M10 Allen bolt w/ washer on lower mount, use threadlocker.

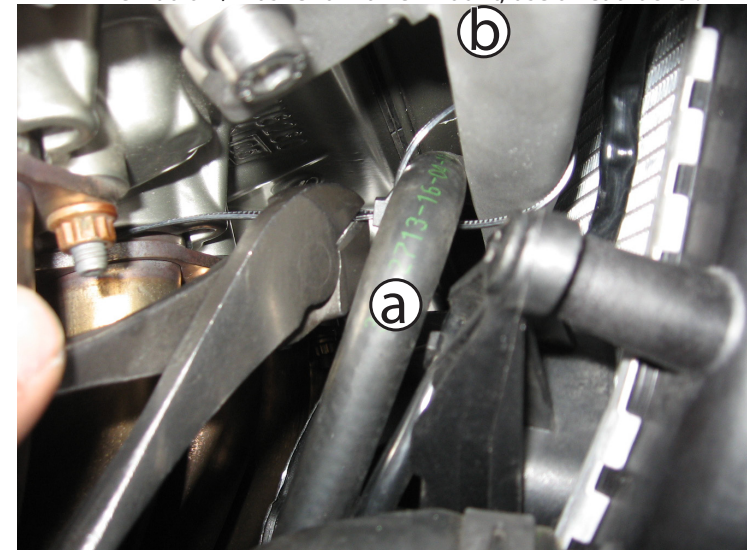

- ⑫ On riders rightside, secure the the coolant hose (a) to the protection bar (b) with (1) zip tie. DO NOT over tighten but rather tighten enough just to hold the hose in position.

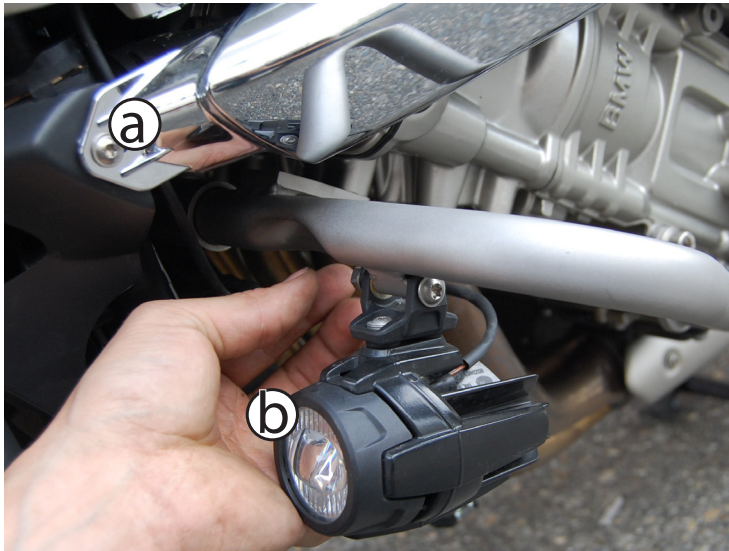

- ⑬ On GTL models, reinstall the Auxillary lights to the mounts on the underside of the new protection bars. Use OEM 10 mm nut and screw. Use (1) zip tie to secure the power cord to engine bar on each side of bike.



- ⑭ Reinstall both the right and left radiator cowls. Take your time and properly align the location pin with rubber grommet. Each side requires the (4) OEM T25 bolts.



Step by Step Installation Video Available Online at [www.altrider.com](http://www.altrider.com)

## CONGRATULATIONS!

**You've completed your installation. If at any point you have questions about your installation or have any feed back for us, we'd love to hear it. A downloadable version of these instructions can be found at our web site. [www.AltRider.com](http://www.AltRider.com)**

**After 5 hours of riding, or 100 miles, check all the fasteners on the assembly to ensure they are tightened to spec.**

**email: info@AltRider.com**  
**phone: +1 206-922-3618**  
**address: 4000 Aurora Ave N**  
**Ste 100**  
**Seattle, WA 98103**

### TERMS OF USE, WARRANTY AND LIABILITY WAIVER

AltRider LLC, a Washington company, having its principal place of business in Seattle, WA ("AltRider") offers its motorcycle accessories (the "Product") with the terms, conditions and notices as follows:

#### Terms of Use

This Product is offered to you conditioned upon your acceptance without modification of the terms, conditions, and notices contained herein. Installation and/or use of this product implies acceptance of all such terms, conditions, and notices. If you do not agree to these terms, do not buy the Product. If you have already bought the Product and do not agree to these terms, return this Product promptly including the packaging and all written materials, to AltRider.

#### Limitation of Liability and Warranty Disclaimer

You may return your merchandise for a full refund or exchange, less any original or return shipping fees under these conditions:

1. Only if the merchandise is in 100% factory condition. Original manufacturer's packaging and same condition as sold – original boxes, packaging material, instructions, documentation, parts, and attached tags.
2. Only unused, unscratched, uninstalled, undamaged merchandise will be accepted. Do not install equipment until you are sure you want to keep it. Package items carefully in protective materials before returning them. Never ship an item in its original manufacturers packaging – it will arrive damaged. Please use a postal box or other adequate packaging to ensure your return or exchange is not damaged on the way back to AltRider.com.

To read more about our exchanges and returns policy, on the web, navigate to <http://www.altrider.com/info/exchangesAndReturns>

Excepting the warranties stated in the preceding paragraph, AltRider hereby disclaims all other warranties and conditions with regard to the Product including all implied warranties and conditions of merchantability and fitness for a particular purpose. There are no warranties which extend beyond the description on the face hereof. AltRider does not warrant against damages or defects arising out of use or installation of the Product. Installation instructions are provided for your convenience. AltRider is not responsible for any damages arising out of the installation, improper or otherwise, of the Product. No warranty of any kind, expressed or implied, is made regarding the safety of this Product.

To the extent allowed by law, AltRider shall not be held liable for any direct, indirect, punitive, incidental, special or consequential damages arising out of, or connected with, the use or misuse of this Product. Buyer assumes all risks and liability arising from use of this Product.

#### Entire Agreement

This document states the entire obligation of AltRider with respect to the Product. If any part of this agreement is determined to be void, invalid, unenforceable or illegal, including, but not limited to the warranty disclaimers and liability limitations set forth above, then the remainder of the agreement shall remain in full force and effect.

#### Applicable Law

This agreement is governed by the laws of Washington, USA. You hereby consent to the exclusive jurisdiction and venue of the courts of Washington, USA, in all disputes arising out of or relating to the use of this product.

